

Diaphragm Gas Meter

KEY FEATURES

- High Quality diaphragm gas meter
- Manufactured to ISOEN 359/OIMLR31
- Free calibration certificate with each meter
- For use with coal, natural, marsh gas, LPG and other non-corrosive gases
- All sizes complete with pulsed output
- Pulsed outputs designed for long signal transmission
- Maximum working pressure 100 mbar



METER SIZES G4 to G25

ITEM	UNIT	G4	G6	G10	G16	G25
Nominal Flow Rate	m ³ h	4	6	10	16	25
Qmax	m ³ h	6	10	16	25	40
Qmin	m ³ h	0.04	0.06	0.1	0.16	0.25
Qmax Operating Pressure	kPa	10	10	10	10	10
Permissible Error	B Grade Qmin , 0.1 Qmax +/- 3% 0.1 Qmax , Qmax +/- 1.5%					
Total Pressure Loss	PA	Qmax < 200		Qmax < 300		
Operating Ambient Temperature	C	~ 0 40				
Signal Output	ON - OFF Signal					
Signal Equivalence	m ³ h	0.1				
Signal Width	ms	> 360				
Operating Voltage	V	5 - 12v				
Permission Circuit	mA	< 10				
Specification of the Line Output	AVVR2 x 0.12					
Length of Wire	1000	1000		1500		
Size L*W*H	mm	210*165*233	275*210*295	280*205*325	340*245*380	480*340*565
Pipe Centers	mm	130	180	205	340	340
Net Weight including couplings	kg	2.5	4.5	4.5	6	8
Coupling*	mm	20mm	25mm	30mm	40mm	50mm
Pipe Size**	mm bsp	21 3/4"	25 1"	30 1 1/4"	40 1 1/2"	50 2"
Coupling Thread	Type	11 dens/inch	11 dens/inch	11 dens/inch	11 dens/inch	11 dens/inch
Cover	Aluminum					
Order Code		GD4PS	GD6PS	GD10PS	GD16PS	GD25PS

* Internal Diameters - Coupling is the nut fitting on top of the meter

** Pipe size: Diameter of the pipe which is joined to the gas pipe

INSTALLATION

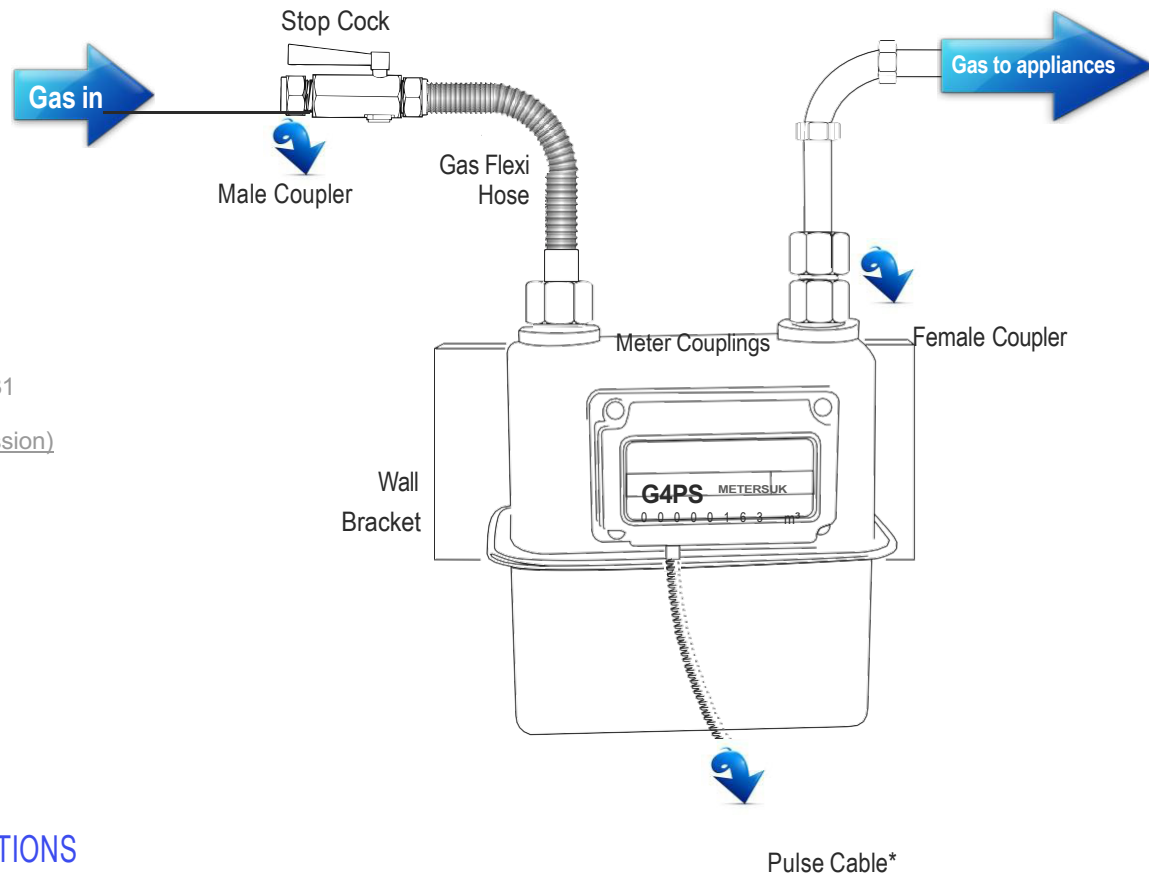

Diaphragm Gas Meter
Manufactured to EN1359/OIMLR31

Male & Female Couplers (Compression)
Manufactured to EN1254-2

Gas Flexi Hose
Manufactured to EN103801: 2003

Stop Cock
Manufactured to EN6676

Wall Mounting Bracket
G4 and G6 sizes only

FREQUENTLY ASKED QUESTIONS

Q: What application are the Diaphragm Gas Meters best suited?

A: From standard domestic housing (G4) to small/medium commercial buildings (G25)

Q: How do I know that the gas meters are of good quality?

A: Manufactured to ISO standards - ISOEN 1359/OIMLR31. Meters UK Ltd are an accredited ISO9001 manufacturer.

Q: How accurate are the meters?

A: Our diaphragm meters fall within the prescribed limits of +/- 2%.

Q: What is the pulsed output facility?

A: This reads the gas consumption and is also used in Building Management Applications.

Q: I don't need a pulsed output facility; do I need to have it?

A: A pulsed output comes standard with the meter. It does not have to be used.

Q: What type of gas is the Diaphragm meter suitable for?

A: Natural/Coal/Marsh gas/LPG and other non-corrosive gases

Q: If I want to reed-connect to the BMS via the pulsed output facility, are there any regulations?

A: Yes, in any potential explosive area, Gas safe regulations require a safety barrier be fitted and also provides a smooth signal to the BMS.